

# WIRED CONTROLLER INSTALLATION MANUAL

## MODEL: WWRCU

### IMPORTANT:

**CAREFULLY READ THIS MANUAL BEFORE INSTALLATION, AND FOLLOW THE INSTRUCTIONS TO INSTALL. PLEASE HAND THIS MANUAL TO THE USER AFTER INSTALLATION. FOR THE DETAILS ON HOW TO USE THE WIRED CONTROLLER, PLEASE READ THE OPERATION MANUAL. PROPERLY KEEP THIS MANUAL FOR FUTURE REFERENCE.**

### 1 Safety precautions

Be sure to read safety precautions in the wired controller operation manual carefully before installation, and install correctly.

### 2 Checking accessories

Before installation, check if below accessories are included in the unit:

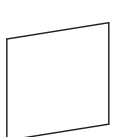
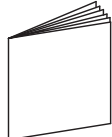
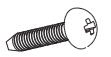
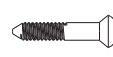
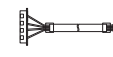
Installation manual	Operating manual	Tapping screw	Wood screw	Connection cord
				
( 1pc )	( 1pc )	( 2pcs )	( 2pcs )	( 1pc )

### 3 How to install

#### 1. Selecting the Installation Location.

Please select a safe installed location.

#### 2. Prepare a hole through the wall to pass the wired controller cord.

(If the wires are taken out from rear side.)

Unit: inch (mm)

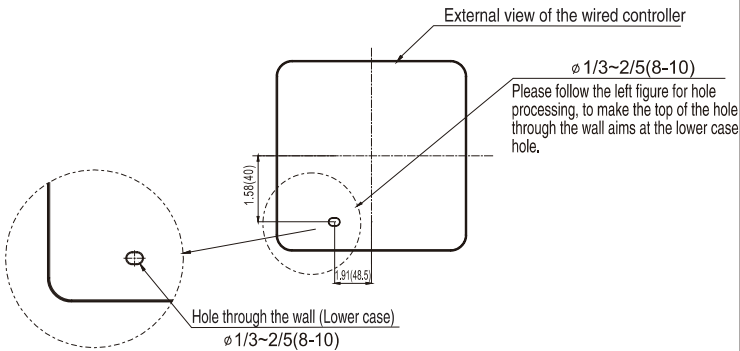

**Note:**

If through hole is too large or deviated from specified location, it maybe exposed.

#### 3. Removing the upper cover of wired controller.

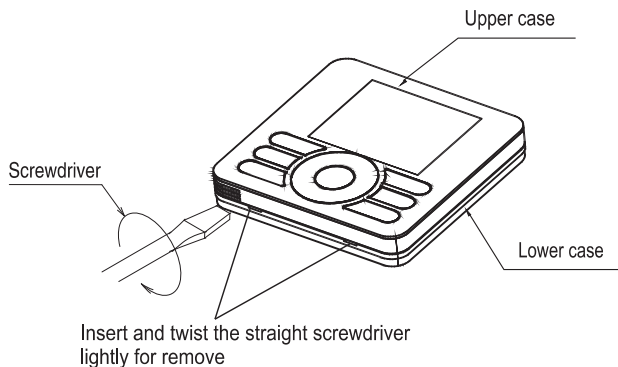

**Note:**

Control board is placed on upper case. Please protect it from scratching when removing!

#### 4. Pass the wired controller cord out of the lower case.

There are two ways to pass remote controller cord out, please select according to actual situation.

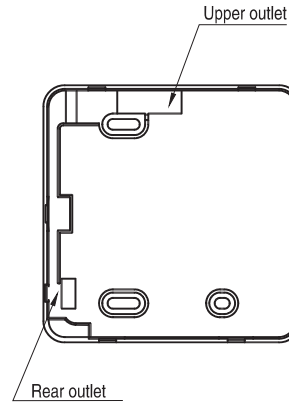

#### 5. Connect the remote controller cord to the terminal block.

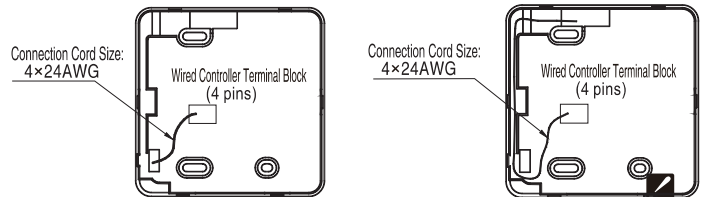

Connect wired controller terminal block with indoor terminal block by connection cord. Details please refer to indoor wiring diagram.

**Note:** Please fasten the cord after connection.

In order to prevent water, insects etc. into the wire outlet, please seal the entrance with putty (field-supplied).

#### 6. Lower Case Fixing

##### ① For Direct Installation on the Wall

Please fix lower case with wood screws (2pcs) in accessories.

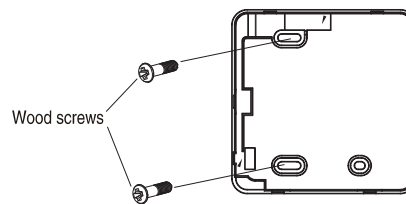

##### ② For Installation on the Switch Box

Please fix lower case with tapping screws (2pcs) in accessories.

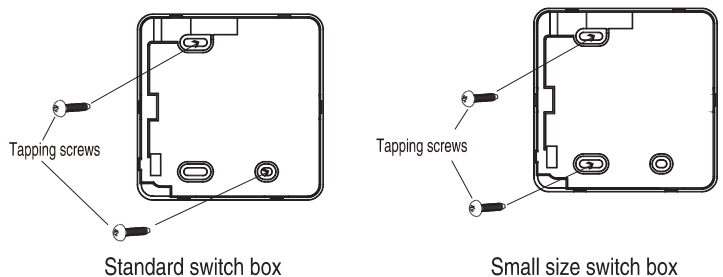

## 4 Custom parameters

The internal parameters of the wired controller can be set with the actual usage conditions. The catalogue of custom-setting parameters is shown as follows:

Custom-setting parameter code	Implication of code display	Description	Remarks
01	Version No.		
03	boot	Restore factory default	
05	Is remote control/button operation setting permitted or not	0-Remote control/button permitted; 1-Reserved; 2-Button prohibited; 3-Remote control/button prohibited 125-Remote control prohibited.	The factory setting defaults to 0
06	Temperature display setting	0-Display the set temperature; 1-Display the indoor room temperature	
07	Temperature measurement unit display setting	0-Display in Celsius; 1-Display in Fahrenheit degree	
08	Cooling-only setting	0-Heat pump type air conditioner; 1-Cooling-only air conditioner	
10	Temperature limits revision setting	0-Prohibited; 1-Permitted	
11	Room temperature revision setting	0-Prohibited; 1-Permitted	

### The method of setting the custom parameters

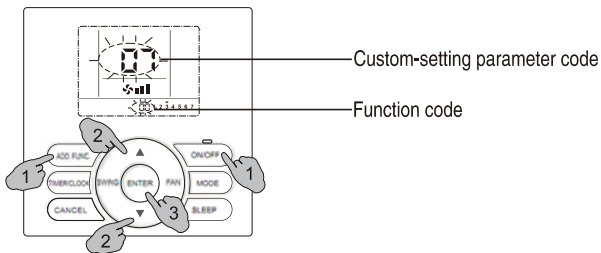

- 1 Press and hold "ADD FUNC." and "ON/OFF" buttons at the same time for 3s, to access the custom-setting mode, and the custom-setting parameter code will flicker on the screen.
- 2 Press the "▲" button (add) or "▼" button (minus) to select the custom-setting parameter code that is required to be set, and press the "ENTER" button, with the function code displayed in flickering.
- 3 Press the "▲" (add) button or "▼" (minus) button to select the function code, and press "ENTER" button to confirm the setting.

#### How to exit:

Press "Cancel" button to exit when any custom-setting code is displayed.

## 5 Parameter setting

The wired controller room temperature display, limit set temperature can be revised if needed. Before setting, please check if these parameters are enabled to be revised, for details, see **Custom parameters**.

### 1. Room temperature correction

Setting of room temperature correction is for particular cases (e.g. installation location near the marble wall): wired controller is set to display room temperature, but the room temperature detected is different from the actual room temperature, so setting correction is necessary.

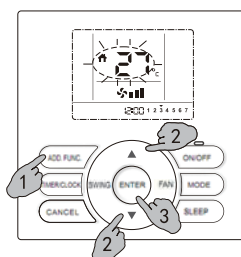

Room temperature correction

#### Setting method:

- 1 Under the OFF conditions, press the "▲" or "▼" button to display the icon.
- 2 Hold down the "ADD FUNC." for 3s, the buzzer will beep four times to alert that it goes into the room temperature modification state. The room temperature value and icon start flickering at the same time.
- 3 Press the "▲" (add) button or "▼" (minus) button to select the room temperature value within an offset of  $\pm 10^{\circ}\text{F}/^{\circ}\text{C}$  of the current temperature, press the "ENTER" button to confirm the setting, save the setting and exit.

#### How to cancel:

Under room temperature correction mode, press "CANCEL" button to cancel correction and exit. Press any other button (except MODE button) to exit room temperature correction directly.

### 2. Temperature limit setting

Default temperature range is (61~86) $^{\circ}\text{F}$  [(16-30) $^{\circ}\text{C}$ ]. You can change the range when needed.

For example, in cooling mode, temperature adjustment range could be changed to (73-86) $^{\circ}\text{F}$  [(23-30) $^{\circ}\text{C}$ ]; in heating mode, it could be changed to (61-73) $^{\circ}\text{F}$  [(16-23) $^{\circ}\text{C}$ ]. The temperature limit is only effective for the cooling and heating modes.

#### Setting method:

- 1 Under the OFF conditions, press down the "▲" (add button) or "▼" (minus button) to adjust the wire remote controller to display .
- 2 Hold down the "ADD FUNC." button for 3s, and the buzzer will beep four times to alert that it goes into the setting temperature limit state. The wire remote controller's limit temperature value and icon will flicker.
- 3 Press the "▲" button (add) or "▼" button (minus) to adjust the temperature limit value within the range of (61~86) $^{\circ}\text{F}$  [(16-30) $^{\circ}\text{C}$ ], and if you press the "MODE" button, it will change in the following sequence:



Press "ENTER" button to save the change and exit. After setting, the limit temperature icon and I numerical value icons stop flickering.

## 6 Well mount the upper cover

Align the upper cover with the hasp of lower cover of wire remote controller, and then press the upper cover onto the lower cover. After installation, tear off protective sticker attached on the display of wired controller.

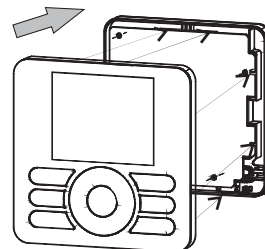

#### ! WARNING

This product can expose you to chemicals including Plumbum, which is known to the State of California to cause cancer and birth defects or other reproductive harm.

For more information go to [www.P65Warnings.ca.gov](http://www.P65Warnings.ca.gov).

WESTINGHOUSE and INNOVATION YOU CAN BE SURE OF are trademarks of Westinghouse Electric Corporation.  
Used under license by FUJITSU GENERAL AMERICA, INC. All Rights Reserved